

HOW THE IFH STORAGE & DISPENSING SYSTEM IS FILLED

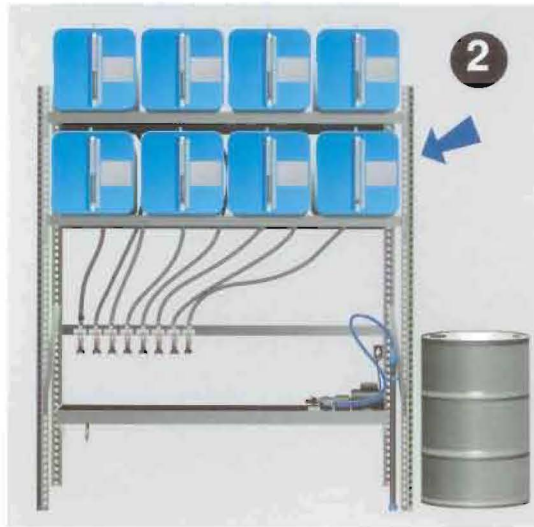

1
Sight gauge on a container (hydraulic oil in this example) indicates 10 gallons or less.



2
New drum of product is located next to system.

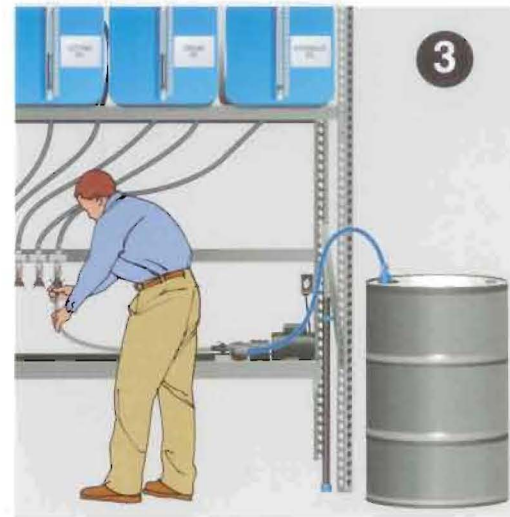

3
Operator inserts suction tube in the full drum of product, and connects the transfer hose from the pump to the appropriate quick connect at the valve arrangement.

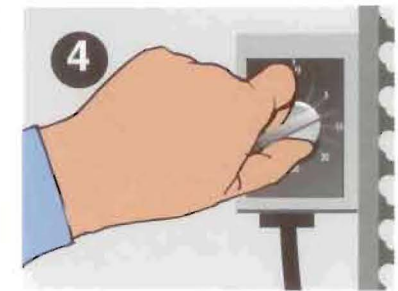

4
Timer-actuator switch is set to initiate the pumping process. The product is now pumped from the drum, through the valving arrangement, and up to the container (a check-valve, in the valve arrangement prevents the back-flow of product).

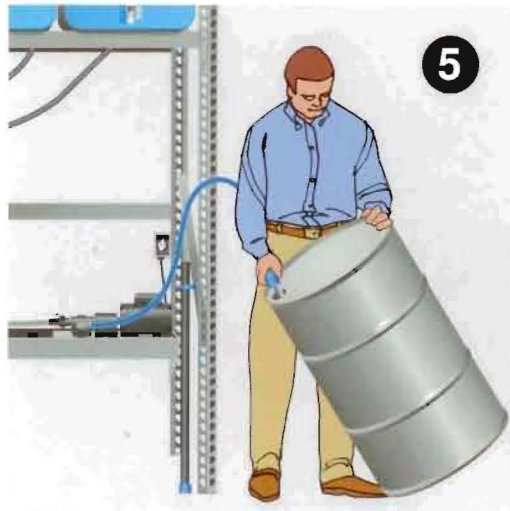

5
The remaining few gallons in the drum are now evacuated by tipping the drum at approximately 30 degrees, with the suction tube placed at the bottommost portion of the drum.



6
The positive displacement pump will completely evacuate all product from the drum.

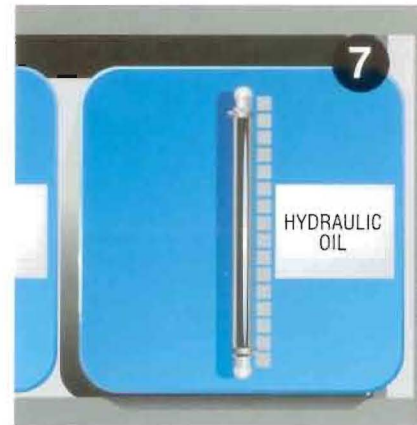

7
The container is now filled to 65 gallons.

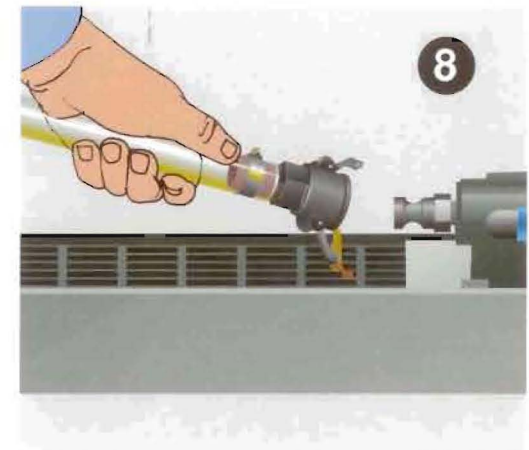

8
The operator now disconnects the transfer hose (via the quick-connect) at the pump end, and drains the residual fluid from the transfer hose into the drip pan. This prevents product cross-contamination the next time a container is refilled.